

Drymec

Centrifugal condensate separator

The CCS range of steel centrifugal separators are suitable for use following aftercoolers or as a very coarse pre filter.

Model	Duty cfm	Connections	£ net
CCS 21	74	1"	135
CCS 49	173	1½"	150
CCS 129	456	2"	165
CCS 165	583	2½"	250
CCS 210	742	DN 80 PN 16	460
CCS 315	1112	DN 100 PN 16	495
CCS 515	1819	DN 125 PN 16	595
CCS 750	2525	DN 125 PN 16	885

Max working pressure 15 bar g

Drain options SCG 20 – indicated or Solenoid drain



Model	Connections	Dimensions mm				kg
		A	B	C	D	
CCS 21	½" BSP	190	390	70	114	3.8
CCS 49	1½" BSP	200	390	80	114	4.0
CCS 129	2" BSP	240	400	90	133	6.1
CCS 165	2½" BSP	280	440	115	168	8.5
CCS 210	DN80 PN16	360	510	130	168	20.0
CCS 315	DN100 PN16	400	570	150	193	29.0
CCS 515	DN125 PN16	440	750	170	219	41.0
CCS 750	DN125 PN16	490	780	190	245	52.0

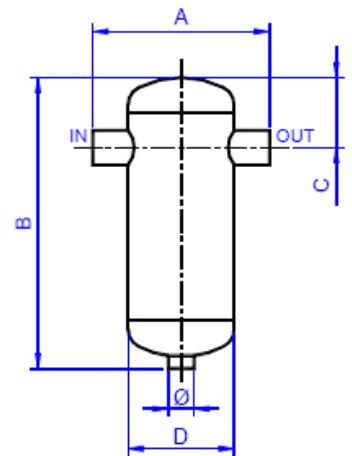

DRYMEC Ltd.

Unit 4R Bramhall Moor Technology Park
Pepper Road
Hazel Grove
Stockport SK7 5BW

Tel 0161 487 4747
Fax 0161 487 3778
www.drymec.com
sales@drymec.com